

Getting Started

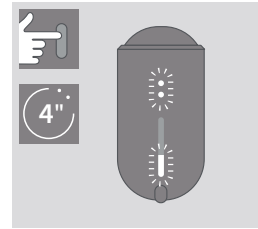

TURN ON

Press and hold Pocket Charger Button for 4 seconds, then release; Pocket Charger Status Lights and Holder Status Lights will turn on slowly.

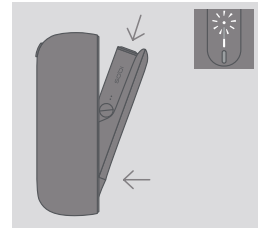

CHARGE HOLDER

Insert Holder into the Pocket Charger, to charge. Holder Status Light will show Holder battery level.

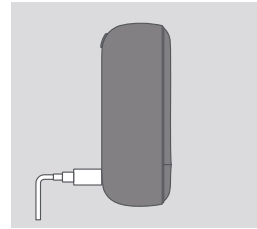

CHARGE POCKET CHARGER

Before first use, fully charge your device with Power Adaptor and Charging Cable. (approx. 135 min)

How to use your IQOS ILUMA™

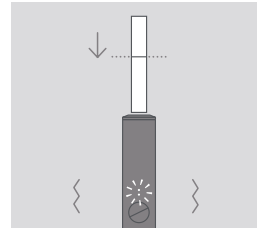

1. INSERT SPECIFICALLY DESIGNED TOBACCO STICK

Insert the specifically designed tobacco stick to the line on filter until Holder vibrates and Light(s) pulse(s).

Heating starts automatically, or by pressing Button for 1 second.

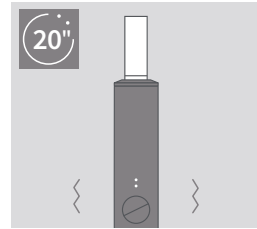

2. BEGIN USE

Start using once Holder vibrates and Lights stay fixed.

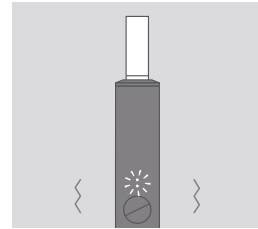

3. NEARLY COMPLETE

To signal the last 30 seconds or last 2 puffs, Holder will vibrate with Light(s) pulsing white.

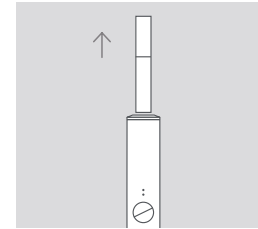

4. REMOVE SPECIFICALLY DESIGNED TOBACCO STICK

Removed used specifically designed tobacco stick and dispose as per Safety Warnings and Instructions.

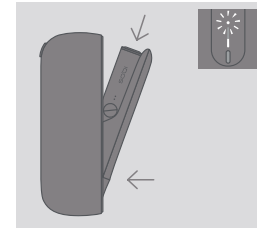

5. RECHARGE HOLDER

Insert the Holder in the Charger for recharging.

Quick Tips

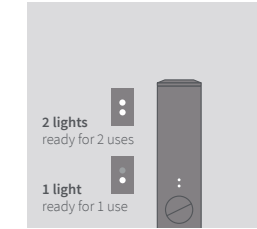

CHECK HOLDER STATUS

Tilt Holder towards you or short press Button, Holder Lights indicate Holder battery level.

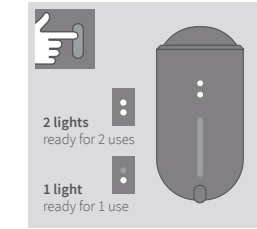

CHECK HOLDER STATUS ON THE POCKET CHARGER

Short press Pocket Charger Button. Holder Status Light will turn on.

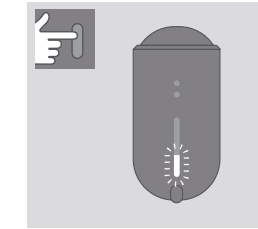

CHECK POCKET CHARGER STATUS

Short press Pocket Charger Button. Pocket Charger Status Lights will turn on to indicate battery level.

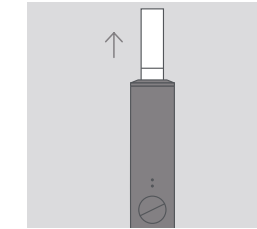

AUTOSTOP

During use, the experience will stop if the specifically designed tobacco stick is moved, or removed from the Holder.

IQOS ILUMA™ POCKET CHARGER

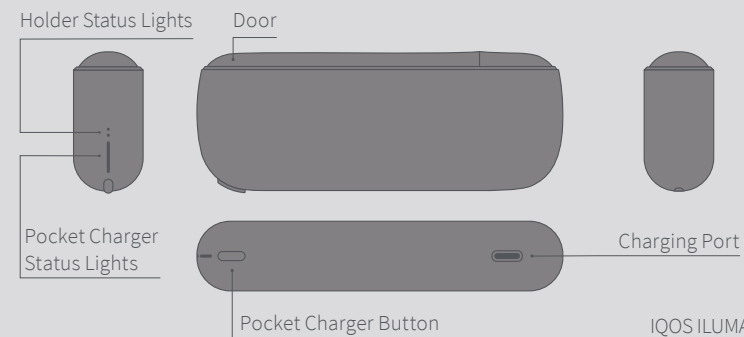

IQOS ILUMA™ HOLDER

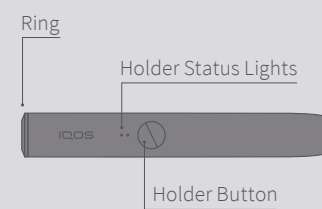

IQOS ILUMA™ is compatible only with SPECIFICALLY DESIGNED TOBACCO STICKS

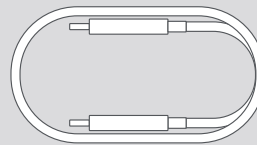

Charging Cable

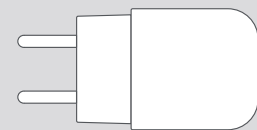

Power Adaptor



For the **full user guide**, **Customer Care** and **Extended support services for IQOS users**, visit

www.iqos.com/myiqos

FEATURES AND SETTINGS

Can be turned on or off with the IQOS app*.

Please register by scanning QR code or log in on www.iqos.com/iluma and follow the instructions.

* IQOS app may not be available in your country.

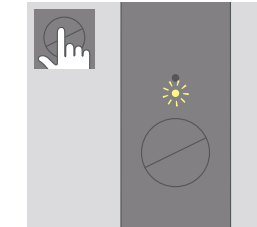

LIGHT BLINKS YELLOW

Battery depleted, need to charge.

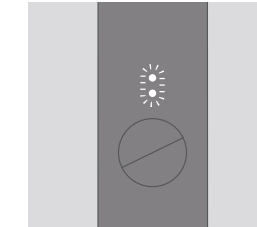

LIGHTS BLINK WHITE TWICE
IQOS ILUMA™ is outside operating temperature range (0°C~40°C).

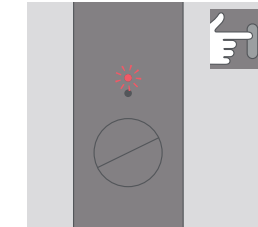

LIGHT BLINKS RED

Reset Pocket Charger. If red light blinking persists, contact Customer Care.

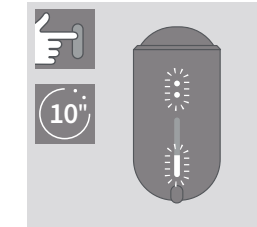

TO RESET

Place Holder in Pocket Charger and press Button for 10 seconds then release. All Status Lights will turn OFF, and turn ON, to confirm a RESET.

So starten Sie

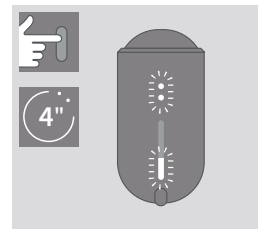

EINSCHALTEN

Halten Sie die Power-Taste am Pocket Charger 4 Sekunden lang gedrückt und lassen Sie sie dann los. Die Ladestatus-LEDs für Pocket Charger und Holder leuchten langsam auf.

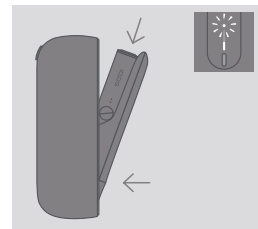

HOLDER LADEN

Setzen Sie den Holder in den Pocket Charger ein, um mit dem Ladevorgang zu beginnen. Die Holder Ladestatus-LEDs am Pocket Charger zeigen den Ladefortschritt an.

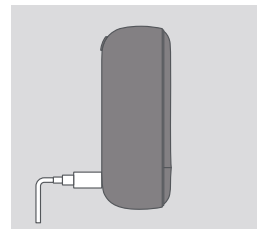

POCKET CHARGER LADEN

Laden Sie Ihr IQOS ILUMA™ vor der ersten Verwendung mit dem USB-Netzteil und -Ladekabel auf. (Dauer: ca. 135 Min.)

So benutzen Sie Ihr IQOS ILUMA™

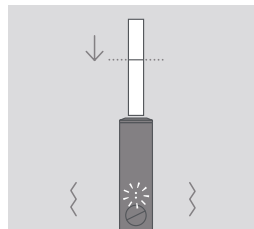

1. SPEZIELL ENTWICKELTEN TABAKSTICK EINSETZEN

Setzen Sie den speziell entwickelten Tabakstick bis zur Linie am Filter ein, bis der Holder vibriert und die LEDs pulsieren.

Die Erhitzung startet automatisch. Alternativ können Sie die Holder Power-Taste 1 Sekunde lang gedrückt halten.

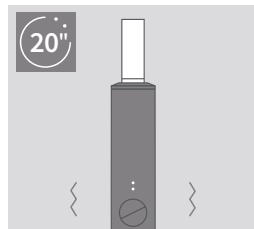

2. VERWENDUNG STARTEN

Sie können Ihr IQOS ILUMA™ verwenden, sobald der Holder erneut vibriert und die LEDs nicht mehr blinken.

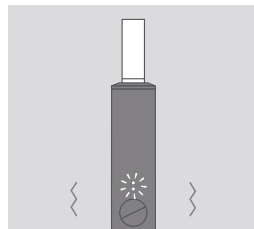

3. ENDE DER TABAKERHITZUNG

Um die letzten 30 Sekunden der Nutzungsdauer oder die letzten beiden Züge zu signalisieren, vibriert der Holder und die LEDs pulsieren erneut weiß.

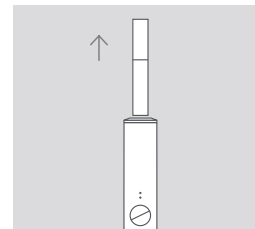

4. SPEZIELL ENTWICKELTEN TABAKSTICK ENTFERNEN

Entfernen Sie den speziell entwickelten Tabakstick und entsorgen Sie ihn wie in den Sicherheits- und Warnhinweisen angegeben.

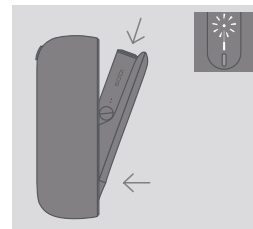

5. HOLDER NEU LADEN

Setzen Sie den Holder in den Pocket Charger ein, um ihn erneut zu laden.

Nützliche Hinweise

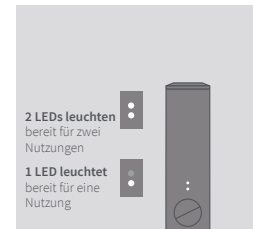

ÜBERPRÜFEN DES HOLDER LADESTATUS

Neigen Sie den Holder in Ihre Richtung oder drücken Sie kurz die Holder Power-Taste, damit die LEDs den Ladestatus des Holders anzeigen.



ÜBERPRÜFEN DES HOLDER LADESTATUS AM POCKET CHARGER

Drücken Sie kurz die Power-Taste am Pocket Charger. Die Holder Ladestatus-LEDs am Pocket Charger leuchten auf.

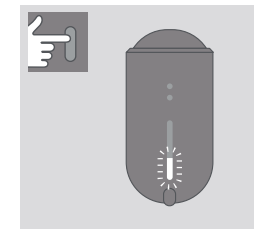

ÜBERPRÜFEN DES POCKET CHARGER LADESTATUS

Drücken Sie kurz die Power-Taste am Pocket Charger. Die nun aufleuchtenden LEDs zeigen den Ladestatus an.

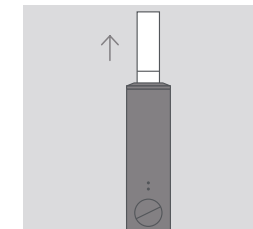

AUTOSTOPP

Ihr IQOS ILUMA™ schaltet sich automatisch aus, falls der speziell entwickelte Tabakstick während der Nutzung im Holder bewegt oder vollständig entfernt wird.

IQOS ILUMA™ POCKET CHARGER



IQOS ILUMA™ HOLDER

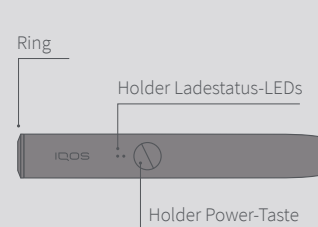

IQOS ILUMA™ ist nur mit SPEZIELL ENTWICKELTEN TABAKSTICKS kompatibel.

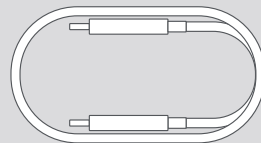

USB-Ladekabel

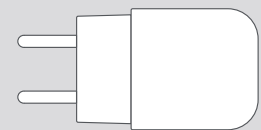

USB-Netzteil



Die **vollständige Bedienungsanleitung** und **Informationen zu IQOS CARE** finden Sie auf

www.iqos.com/myiqos

FUNKTIONEN UND EINSTELLUNGEN

können mit der IQOS app* ein- und ausgeschaltet werden.

Registrieren Sie sich bitte, indem Sie den QR-Code scannen oder melden Sie sich auf www.iqos.com/iluma an und folgen Sie den Anweisungen.

* Möglicherweise ist die IQOS app nicht in Ihrem Land verfügbar.

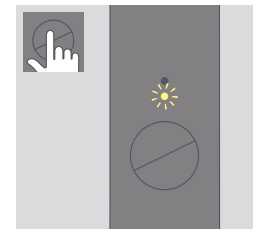

LED BLINKT GELB

Der Akku des Holders ist leer. Bitte laden Sie ihn auf, um den Holder erneut nutzen zu können.

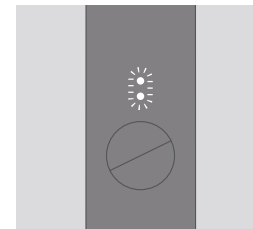

LEDS BLINKEN ZWEI MAL WEISS

Ihr IQOS ILUMA™ befindet sich außerhalb des empfohlenen Temperaturbereichs (<0 °C/>40 °C).

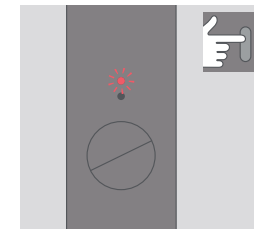

LED BLINKT ROT

Setzen Sie den Pocket Charger zurück. Wenn die LED nicht aufhört rot zu blinken, wenden Sie sich an IQOS CARE.

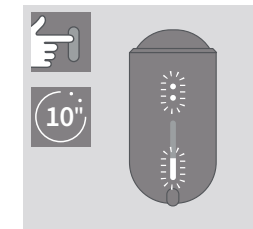

ZURÜCKSETZEN

Setzen Sie den Holder in den Pocket Charger ein, halten Sie die Power-Taste 10 Sekunden lang gedrückt und lassen Sie sie dann los. Alle Ladestatus-LEDs gehen aus und wieder an, um zu bestätigen, dass das System zurückgesetzt wurde.

Pour commencer

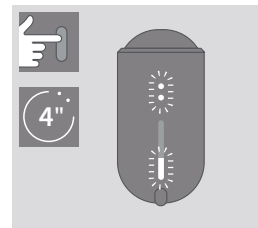

ALLUMEZ

Appuyez sur le bouton du Chargeur de Poche pendant quatre secondes, puis relâchez ; Les voyants d'état du Chargeur de Poche et du Stylet s'allument progressivement.

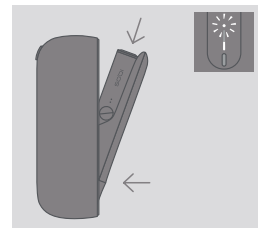

CHARGEZ LE STYLET

Insérez le Stylet dans le Chargeur de Poche pour le charger. Le voyant d'état du Stylet indique son niveau de charge.

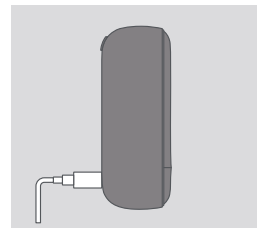

CHARGEZ LE CHARGEUR DE POCHE

Avant sa première utilisation, chargez complètement votre appareil avec l'adaptateur secteur et le câble de chargement. (environ 135 min)

Comment utiliser votre IQOS ILUMA™

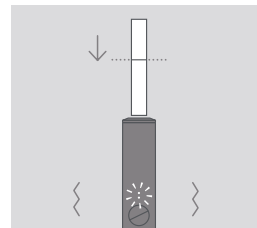

1. INSÉREZ LA RECHARGE DE TABAC CONÇUE SPÉCIFIQUEMENT

Insérez la recharge de tabac conçue spécifiquement dans le Stylet jusqu'à la ligne du filtre. Le Stylet vibre et le(s) voyant(s) clignote(nt). Le Stylet commence à chauffer automatiquement. Sinon appuyez sur le bouton pendant une seconde.

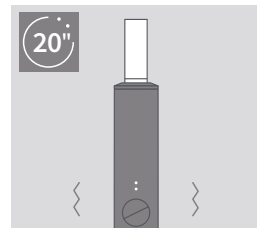

2. COMMENCEZ L'UTILISATION

Commencez l'utilisation une fois que le Stylet vibre et que les voyants restent fixes.

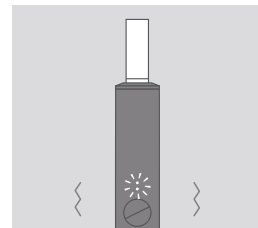

3. FIN IMMINENTE

Le Stylet vibre à nouveau et le(s) voyant(s) clignote(nt) en blanc pour signaler les 30 dernières secondes d'utilisation.

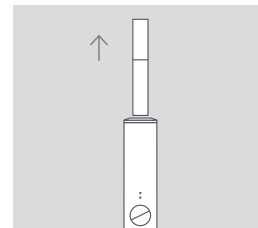

4. RETIREZ LA RECHARGE DE TABAC CONÇUE SPÉCIFIQUEMENT

Retirez la recharge de tabac conçue spécifiquement usagée et jetez-la conformément aux instructions et avertissements de sécurité.

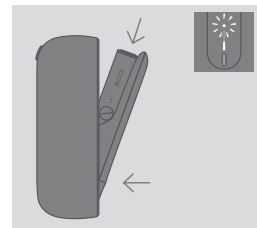

5. RECHARGEZ LE STYLET

Insérez le Stylet dans le Chargeur de Poche pour le recharger.

Astuces rapides



POUR VÉRIFIER LE NIVEAU DE CHARGE DU STYLET

Inclinez le Stylet vers vous ou appuyez brièvement sur le bouton : le(s) voyant(s) du Stylet indique(nt) son niveau de charge.



POUR VÉRIFIER LE NIVEAU DE CHARGE SUR LE CHARGEUR DE POCHE

Appuyez brièvement sur le bouton du Chargeur de Poche. Les voyants d'état du Stylet s'allument.

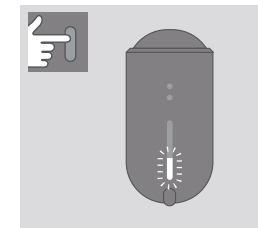

POUR VÉRIFIER LE NIVEAU DE CHARGE DU CHARGEUR DE POCHE

Appuyez brièvement sur le bouton du Chargeur de Poche. Les voyants d'état du Chargeur de Poche s'allument pour indiquer son niveau de charge.

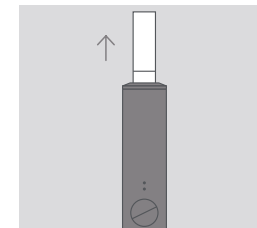

AUTO-STOP

L'utilisation s'arrête automatiquement si la recharge de tabac conçue spécifiquement est déplacée ou retirée du Stylet.

CHARGEUR DE POCHE IQOS ILUMA™

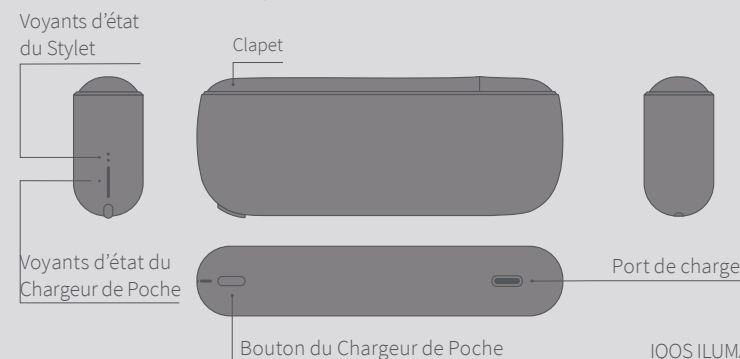

STYLET IQOS ILUMA™

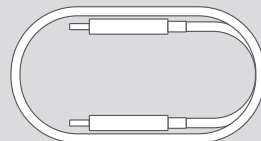
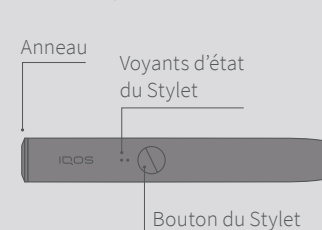

Câble de chargement

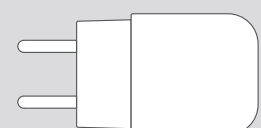

Adaptateur secteur

IQOS ILUMA s'utilise uniquement avec des RECHARGES DE TABAC CONÇUES SPÉCIFIQUEMENT



Pour **consulter le mode d'emploi complet, accéder au Service client et à l'assistance étendue pour les utilisateurs IQOS, rendez-vous** sur

www.iqos.com/myiqos

CARACTÉRISTIQUES ET RÉGLAGES

Peuvent être activés ou désactivés avec l'appli IQOS*.

Enregistrez-vous en scannant le QR code ou en vous connectant sur www.iqos.com/iluma puis suivez les instructions.

* L'appli IQOS n'est peut-être pas disponible dans votre pays.

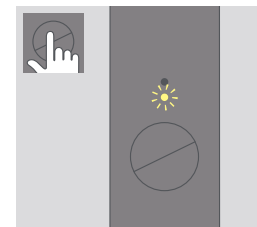

LE VOYANT CLIGNOTE EN JAUNE

Batterie vide, nécessité de la charger.

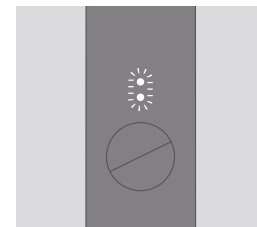

LES VOYANTS CLIGNOTENT EN BLANC DEUX FOIS

IQOS ILUMA™ est en dehors de sa fourchette thermique de fonctionnement (0 °C ~ 40 °C).

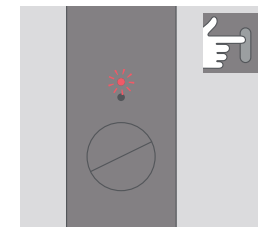

LE VOYANT CLIGNOTE EN ROUGE

Réinitialisez le Chargeur de Poche. Si le voyant rouge continue de clignoter, contactez le Service client.

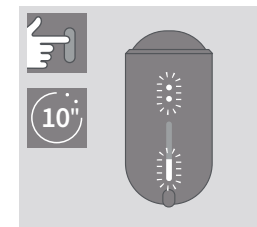

POUR RÉINITIALISER

Placez le Stylet dans le Chargeur de Poche et appuyez sur le bouton pendant 10 secondes avant de le relâcher. Tous les voyants s'éteignent, puis se rallument pour confirmer la réinitialisation.

Per cominciare

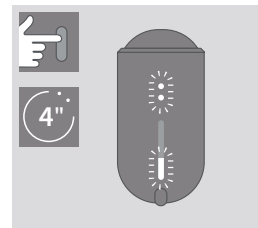

ACCENSIONE
Tenere premuto il pulsante del Caricatore Tascabile per 4 secondi e poi rilasciarlo. Le luci indicanti lo stato del Caricatore Tascabile e dell'Holder si accenderanno lentamente.

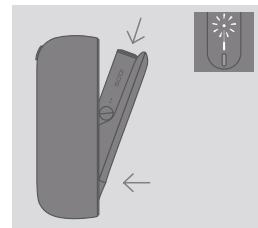

CARICAMENTO DELL'HOLDER
Inserire l'Holder nel Caricatore Tascabile per ricaricare.
La luce che indica lo stato dell'Holder mostrerà il livello di carica raggiunto.

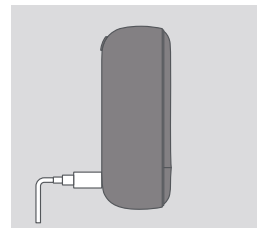

CARICAMENTO DEL CARICATORE TASCABILE
Prima del primo utilizzo, caricare completamente il dispositivo con l'Adattatore di Alimentazione e il Cavo per la Ricarica.
(circa 135 min.)

Come usare il tuo IQOS ILUMA™

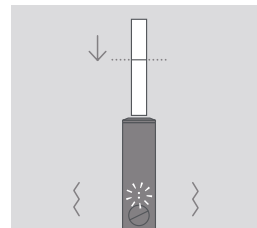

1. INSERIRE LO STICK DI TABACCO APPOSITAMENTE PROGETTATO
Inserire lo stick di tabacco appositamente progettato fino alla linea stampata presente sul filtro finché l'Holder vibrerà e le luci lampeggeranno.
Il riscaldamento inizierà in automatico o premendo il pulsante per 1 secondo.

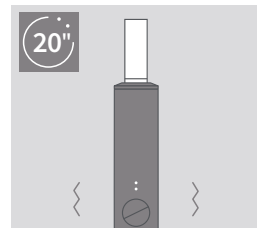

2. PRONTO ALL'USO
Iniziare l'utilizzo quando l'Holder vibra e le luci restano accese.

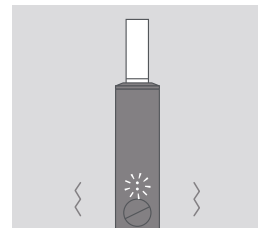

3. QUASI FINITO
Per segnalare che rimangono 30 secondi o solo 2 tiri, le luci bianche dell'Holder lampeggeranno e vi sarà una vibrazione.

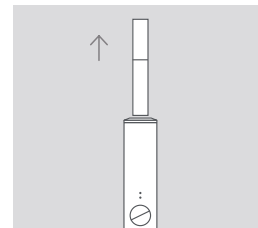

4. RIMUOVERE LO STICK DI TABACCO APPOSITAMENTE PROGETTATO
Rimuovere lo stick di tabacco appositamente progettato usato e smaltirlo secondo quanto indicato nelle Istruzioni e negli Avvisi di Sicurezza.

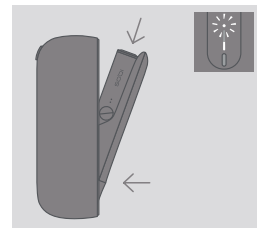

5. CARICAMENTO DELL'HOLDER
Inserire l'Holder nel Caricatore Tascabile per ricaricare.

Consigli pratici



CONTROLLO DELLO STATO DELL'HOLDER
Inclinare l'Holder verso di sé o premere brevemente il pulsante. Le luci dell'Holder indicheranno il livello della batteria.



CONTROLLO DELLO STATO DELL'HOLDER DAL CARICATORE TASCABILE
Premere e rilasciare il pulsante del Caricatore Tascabile. La luce di stato dell'Holder si accenderà.

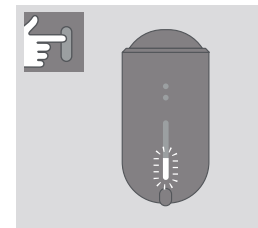

CONTROLLO DELLO STATO DEL CARICATORE TASCABILE
Premere e rilasciare il pulsante del Caricatore Tascabile. Le luci indicanti lo stato del Caricatore Tascabile si accenderanno per indicare il livello della batteria.

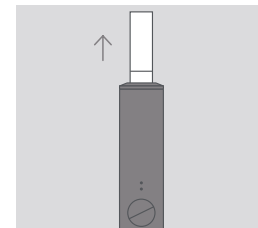

INTERRUZIONE AUTOMATICA
Durante l'uso, il dispositivo si interromperà se lo stick di tabacco appositamente progettato viene mosso o tolto dall'Holder.

CARICATORE TASCABILE IQOS ILUMA™

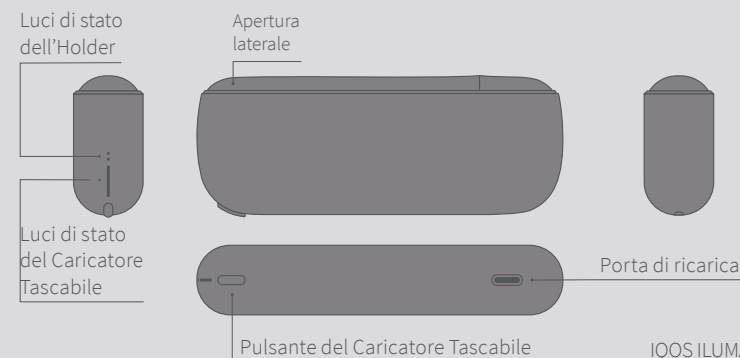

IQOS ILUMA™ è compatibile solo con gli STICK DI TABACCO APPOSITAMENTE PROGETTATI

HOLDER IQOS ILUMA™

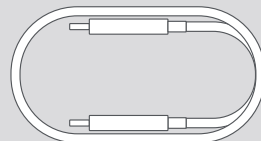

Cavo per la Ricarica

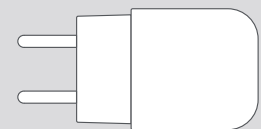

Adattatore di Alimentazione



Per la **Guida utente completa**, per il **Servizio Clienti** e per **servizi di assistenza estesi per gli utenti IQOS**, visita

www.iqos.com/myiqos

LE CARATTERISTICHE E IMPOSTAZIONI

possono essere cambiate tramite l'IQOS app*.

Per registrare il dispositivo, scansiona il codice QR o effettua l'accesso su www.iqos.com/iluma e segui le istruzioni.

* L'IQOS app potrebbe non essere disponibile nel tuo Paese.

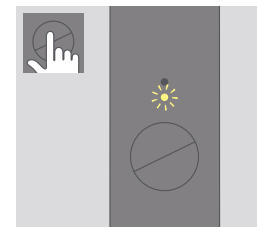

LUCE GIALLA LAMPEGGIANTE
La batteria è scarica e deve essere ricaricata.

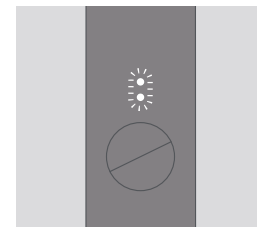

SE LE LUCI BIANCHE LAMPEGGIANO DUE VOLTE
IQOS ILUMA™ è al di fuori della temperatura di funzionamento (ovvero 0° C~40° C).

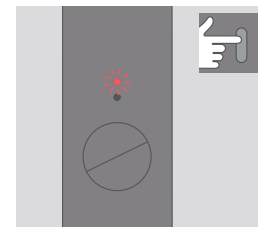

LUCE ROSSA LAMPEGGIANTE
Resettare il Caricatore Tascabile. Se la luce rossa continua a lampeggiare, contattare il Servizio Clienti.

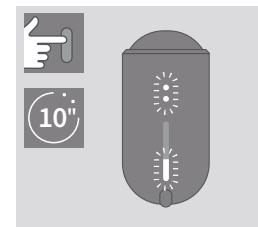

PER RESETTARE
Inserire l'Holder nel Caricatore Tascabile e tenere premuto il pulsante per 10 secondi, poi rilasciarlo. Tutte le luci di stato si spegneranno e si riaccenderanno per confermare il reset del dispositivo.